

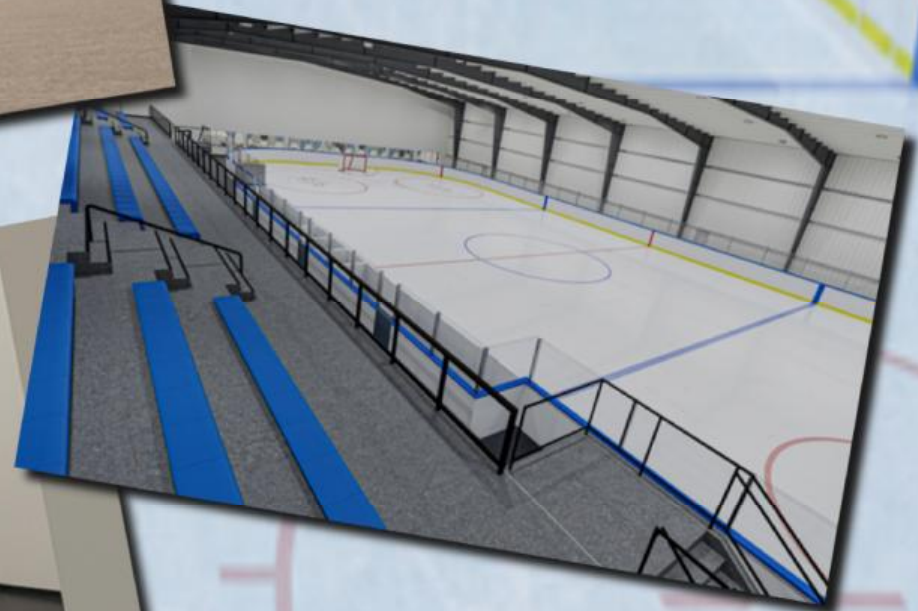

CAISSE
COMMUNITY
CENTRE

La Salle Arena



*Enhancing our Neighbourhood
"Together"*

The Caisse Community Centre Board of Directors are extremely excited to announce that the long awaited La Salle Arena project has been approved through our Municipal and Provincial governments!

With this announcement, we are formally kicking off our fundraising campaign to ensure that we have a facility that the residents of La Salle and the RM of Macdonald can truly be proud of!

The La Salle Arena will be a place for families to come together for a wealth of recreational activities. A place to develop new skills and drive healthy competition. A community focal point where we can face new challenges affecting our municipality. A facility that adds to the word 'HOME'.

With the addition of this much needed amenity, we will ensure that La Salle will remain a desirable place to raise our families. Now and for decades to come! But we need your HELP!

We are asking for your support to make the La Salle Arena the very best it can be! Please consider supporting this project with a donation that will recognize your family or business! Your support will truly make a difference!

Donation information is provided on page 4 of this pamphlet.

The Board of the Caisse Community Centre is deeply grateful for your support!

Arena Features

- The La Salle Arena will be a 31,508 square foot addition to the existing Caisse Community Centre building.
- Includes an NHL-size ice rink with year round ice capability, 6 change rooms, 405 person spectator seating plus indoor viewing area.
- Includes a main floor walking track with heated floor around the ice surface that can be utilized for fitness programming. 3 pickleball courts will be established within the arena for ice offseason.
- The Caisse Community Centre was designed to accommodate the arena addition and will utilize the existing facilities, spectator washrooms, commercial kitchen, canteen, office, lobby, utilities, parking lot etc.
- Highly efficient, modern packaged ice plant not requiring certified operators.

*La Salle Arena
Enhancing our Neighbourhood
"Together"*

Successful Projects at the Caisse Community Centre

- **2013: \$4M current Community Centre**
 - \$1M grant was acquired but could not be used due to an extended approval process.
- **2018: \$750k La Salle Kidz Daycare in the old Community Centre**
 - La Salle Kidz Daycare now also operates a 40 Child Daycare at the La Salle school and is set to operate a new 70 Child Daycare at Prairieview Lakes.
 - \$300k grant was acquired from the Province of Manitoba. No municipal taxes were used for the project.
- **2022: \$250k Caisse Community Centre Baseball Diamond Improvements**
 - \$85k grant from the Toronto Blue Jays.
 - \$77.5k grant from the Province of Manitoba.
 - \$22k RM of Macdonald capital assistance grant.
- **2022: Splash Pad build at the Caisse Community Centre**
 - Funded by the RM of Macdonald which utilized grant funds.
- **2023: \$180k Caisse Community Centre Playground and Courtyard Improvements**
 - \$75k grant from the Province of Manitoba.
 - \$60k RM of Macdonald capital assistance grant.
- **Many other smaller projects and grants have also been accomplished.**

Business Plan

- **Proposed arena schedule would run 10 months a year which provides a much higher revenue than a single season which is the case for all other RM arenas.**
- **Staffing and operational costs will be reduced with a single multiplex, a lot of staff are already in place.**
- **A new energy efficient arena will have reduced operating costs.**

Project Schedule

- **Local Improvement Plan Approval: December 2024**
- **Order Pre-engineered Building: December 2024**
- **Design and Building Permits: January 2025**
- **Construction Start: March 2025**
- **Construction Completion: Spring 2026**
- **Opening: Summer 2026**

La Salle Arena Pledge Form

Pledges to the La Salle Arena Capital Campaign may be made by completing this form
OR by e-transfer to brightfuture@caissecc.com OR scan the QR code.
For Project Information, please visit: www.caissecc.com/lasallearena



I (We) pledge to the La Salle Arena Capital Campaign, a total gift of: \$ _____

I (We) make this contribution in the form of: ☐ cash ☐ credit card ☐ cheque (cheques payable to La Salle Charitable Foundation)

The La Salle Arena and/or Caisse Community Centre will acknowledge all pledges in publications / appropriate places unless otherwise specified by the donor.

☐ I (We) wish to have my (our) pledge acknowledged to _____

(name you wish to see in print)

☐ I (We) wish to have my (our) pledge acknowledged to name _____

(name you wish to see in print)

☐ in honour of or

☐ in memory of

☐ I (We) wish my (our) pledge to be anonymous.

Pledge Information:

Name _____ Address _____

Telephone _____ Email _____

Signature _____ Date _____

Please return this form in confidence to: La Salle Charitable Foundation (charitable registration # 872862917RR0001)
c/o Caisse Community Centre, 80 PR 247E, La Salle, MB R0G 0A1

Items Available for Sponsorship

<u>Item</u>	<u>Amount</u>	<u>Quantity</u>
Individual Seats	\$500	400 (lifetime)
Sound Baffles	\$1,500	50 (name/logo - 10-years)
On-Ice Blueline Logos	\$2,500	4 (logo - 2-years)
Change Rooms x 4 (existing)	\$5,000	4 (name/logo above door / inside wall - 5-years - reference in all programming)
Referee Rooms x 2	\$5,000	2 (name/logo above door / inside wall - 5-years - reference in all programming)
Wall Boards (4 x 8)	\$5,000	10 (name/logo - 5-years)
Rink Boards (2.5 x 10)	\$5,000	26 (name/logo - 5-years)
U7 Dividers & Nets	\$5,000	2 (name/logo - lifetime)
Premium Rink Boards (double sided) x 14 (2.5 x 10)	\$7,500	7 (name/logo - 5-years)
Change Rooms x 6	\$10,000	6 (name/logo above door / inside wall - 5-years - reference in all programming)
U9 Removable Boards & Nets	\$10,000	1 (name/logo - lifetime)
Canteen	\$20,000	1 (name/logo above window & wall menu sign in arena area - reference in all programming)
Raised Indoor Viewing Area	\$50,000	1 (sign above raised indoor viewing area - 10-years)
Zamboni	\$100,000	1 (name/logo - 10-years)
Score Board	\$100,000	1 (name/logo on and around scoreboard - 10-years)
Parking Lot	\$150,000	1 (signage TBD)

La Salle Arena

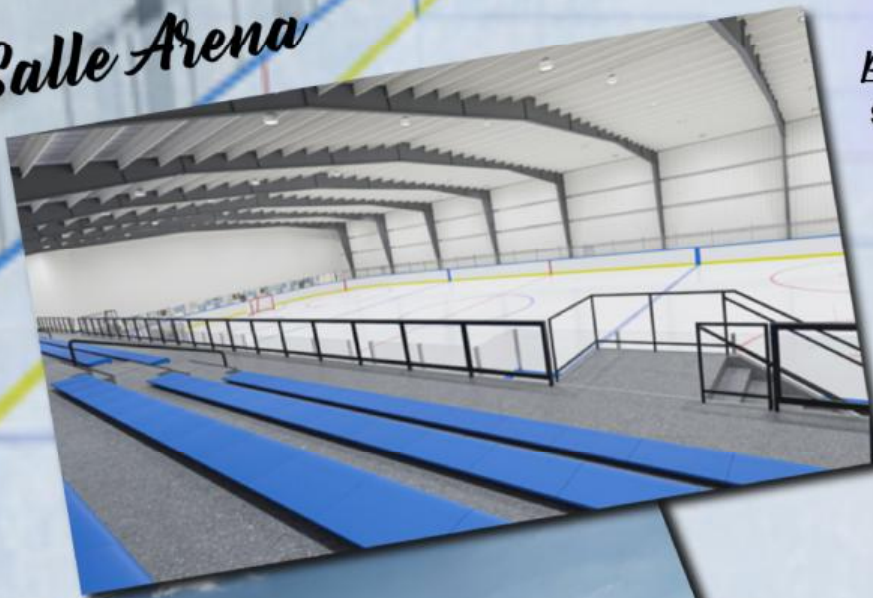

*Enhancing our Neighbourhood
"Together"*

The Caisse Community Centre wishes to recognize the valuable contributions / sponsorships and support of the community and its businesses / individuals by displaying their names on a donor wall which will be displayed in the La Salle Arena. Categories will be used for distinguishing various contribution levels.

<u>Platinum</u>	<u>Gold</u>	<u>Silver</u>	<u>Bronze</u>	<u>Builders</u>	<u>Sustainers</u>
\$100,000+	\$50,000 - \$99,999	\$10,000 - \$49,999	\$5,000 - \$9,999	\$1,500 - \$4,999	\$1,000 - \$1,499

For Project Information:

www.caissecc.com/lasallearena

For Fundraising Information:

brightfuture@caissecc.com

Questions?

arena@caissecc.com

Sponsorship and/or Pledges to the La Salle Arena Capital Campaign may be made by completing the form on page 4 of this OR scan the QR code

